

## Case Studies



## Specifications

Part Number	RSO3.6	RSO4.8
Pixel pitch	3.6mm	4.8mm
LED type	SMD1921	SMD1921
Pixel configuration	1R1G1B	1R1G1B
Size of module(mm)	288x288	288x288
Resolution of module	80x80	60x60
Density(dots/m <sup>2</sup> )	102400	57600
Cabinet material	Die-casting Aluminum	Die-casting Aluminum
Size of cabinet(mm)	576x576x80	500x500x80
Weight of cabinet	8.1kg	8.1kg
Installation Method	Front / Rear installation	Front / Rear installation
Maintenance Method	Front / Rear Maintenance	Front / Rear Maintenance
Max power consumption	600W/m <sup>2</sup>	600W/m <sup>2</sup>
Average power consumption	200W/m <sup>2</sup>	200W/m <sup>2</sup>
Colors	16.7M	16.7M
Gray scale	14bits	14bits
Color temperature	3000-10000K	3000-10000K
Refresh frequency	≥3840Hz	≥3840Hz
Brightness	5000cd/m <sup>2</sup>	5000cd/m <sup>2</sup>
Brightness control	256 grade	256 grade
IP grade	IP65	IP65



### Lightking Tech Group Co.,Ltd.

www.lightking-led.com  
 Building A, Zhongsheng Industrial Park, No. 4  
 Lixin Road, Bao'an District, Shenzhen, China  
 Tel: +86-755-81467007  
 E-mail: service1@lightking.hk

Twitter: @lightkingLED  
 Facebook: Lightking Tech Group Co., Ltd.  
 LinkedIn: Lightking Tech Group Co., Ltd.



For Outdoor  
Rental Application



# RSO SERIES

Lightking Tech Group Co.,Ltd.

## Lightweight and Ultra-Thin Design

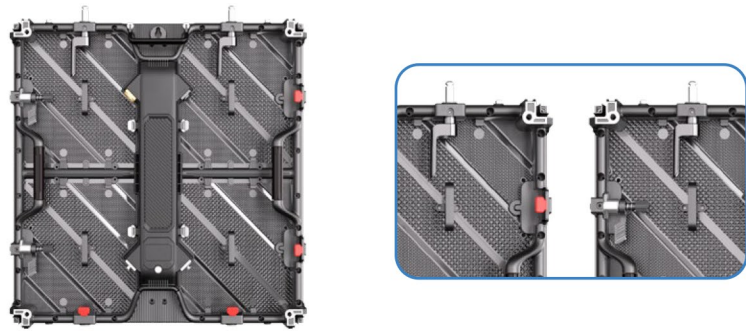

Cabinet size: 576mmx576mmx80mm, panels weighing only 8.1kg each.

## Four-Corner Protection with a Unique Design



Maximum edge protection for modules

## Optimized Bottom Gap Design

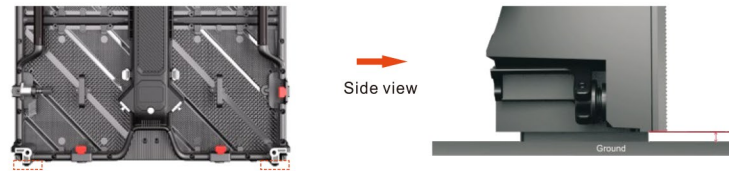

Bottom modules elevated above the floor for enhanced protection

## Effortless and Rapid Installation Process

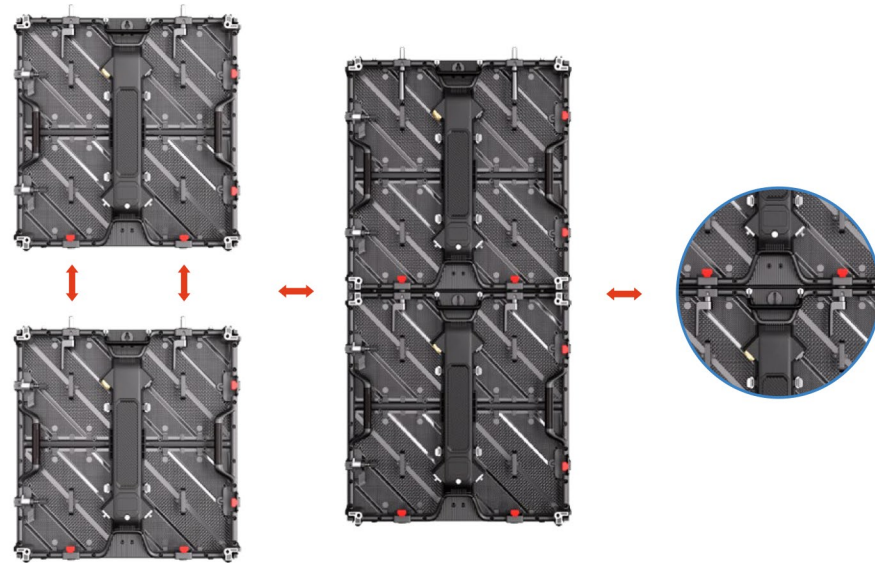

Vertical lock automatically engages when two cabinets are combined, enabling single-person installation with ease.

## Simple and Hassle-free Maintenance

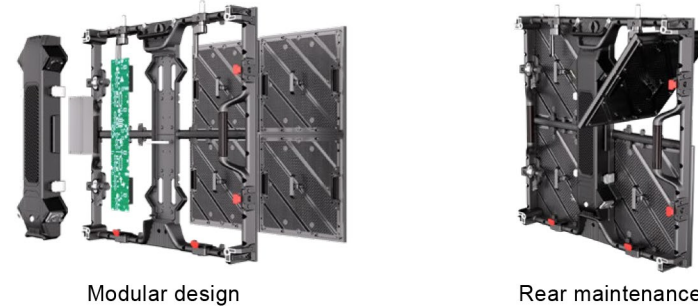

Modular design with effortless pin connection and independent power box for easy maintenance; Modules are consistent, can be placed on both left and right, the data is double backup.

## Hanging Application

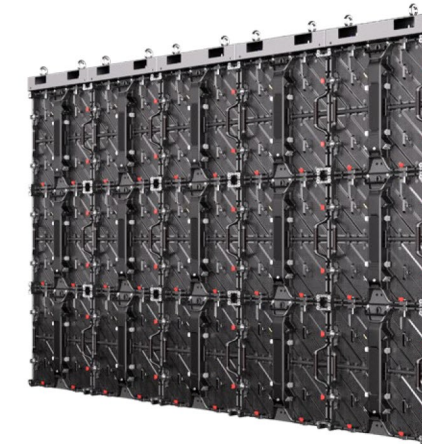

- Die-casting aluminum cabinet, high precision, high reliability.
- The cabinet will not be deformed even hanging 10-meter.

## Stack Assembly with Ground Support System

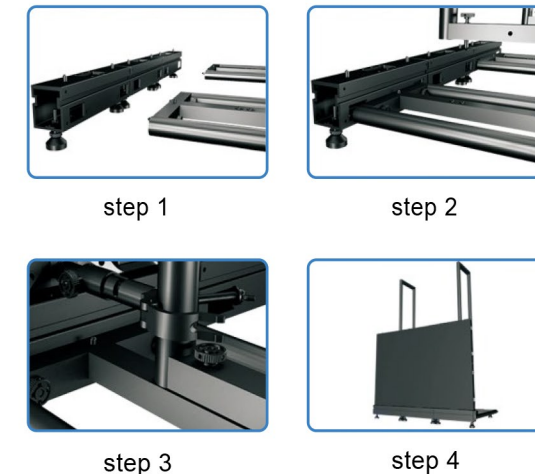

Installation steps

